

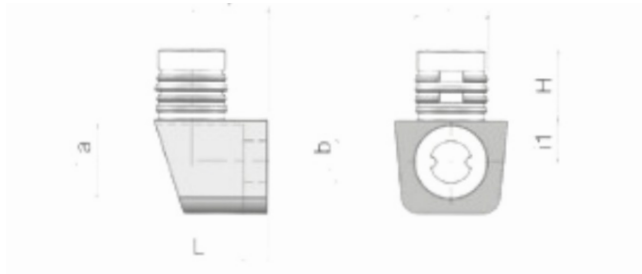

GIUNZIONE BRISK



\varnothing	$\varnothing a$	$\varnothing b$	H	L	L1	i	i1
10,5	10	6	10	13	4	11	6

MATERIALE: *PLASTICA*
FINITURA: BIANCO; MARRONE; NERO

GIUNZIONE BRISK ASSEMBLATA

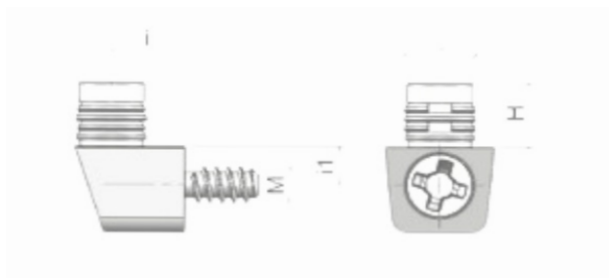

\varnothing	H	i	i1	M
10.5	10	11	6	6 euro

MATERIALE: *PLASTICA*
FINITURA: BIANCO; MARRONE; NERO



GIUNZIONE BRISK II

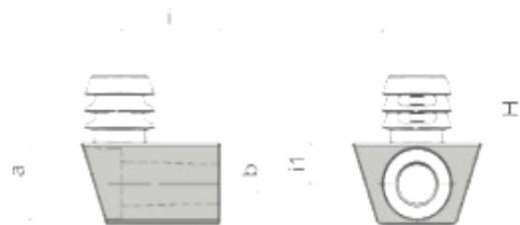

\varnothing	$\varnothing a$	$\varnothing b$	H	i	i1
10.5	10	6	10	15.5	6

MATERIALE: *PLASTICA*
FINITURA: BIANCO; MARRONE; NERO

VITE



\varnothing	L	M
10	14	6euro

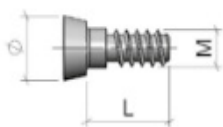

MATERIALE: *FERRO*
FINITURA: GREZZO; ZINCATO