

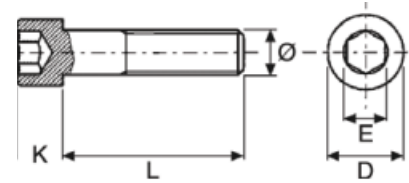

DIN 912  
UNI 5931  
ISO 4762

## VITE A TESTA CILINDRICA CON CAVA ESAGONALE



CLASSE 8.8

Ø	M6	M8	M10	M12	M16
D	5	6	8	10	14
E	6	8	10	12	16
K	10	13	16	18	24
L	8-110	12-110	16-120	20-120	30-120

ZINCATE BIANCHE	PREZZO
Ø x L	€/100 pz
3x6	5,51 €
3x8	5,38 €
3x10	5,38 €
3x12	5,51 €
3x16	5,61 €
3x20	6,30 €
4x4	4,75 €
4x6	6,05 €
4x8	4,75 €
4x10	3,95 €
4x12	3,65 €
4x14	3,65 €
4x16	3,55 €
4x20	3,80 €
4x25	4,30
4x30	4,70
4x35	5,50
4x40	6,20
4x45	8,75

ZINCATE BIANCHE	PREZZO
Ø x L	€/100 pz
5x8	5,15
5x10	4,25
5x12	3,95
5x14	4,20
5x16	3,90
5x18	4,15
5x20	4,20
5x25	4,90 €
5x30	5,50 €
5x35	6,40 €
5x40	7,30
5x45	8,15
5x50	9,80
5x60	12,45
6x8	6,2
6x10	5,70
6x12	5,00
6x14	5,20
6x16	5,20
6x18	5,95



ZINCATE BIANCHE	PREZZO
Ø x L	€/100 pz
6x20	6,00
6x22	6,75
6x25	6,75
6x30	7,35
6x35	8,40
6x40	9,35
6x45	10,25
6x50	12,45
6x55	13,95
6x60	15,85
6x65	17,65
6x70	20,15
6x80	26,10
6x90	29,60
6x100	33,30
6x110	38,25
8x12	9,40
8x14	9,45
8x16	9,35
8x20	9,85
8x25	10,90
8x30	12,15
8x35	14,50
8x40	15,45 1
10x16	18,05
10x20	18,95
10x25	20,80
10x30	22,45
10x35	24,00
10x40	25,70
10x45	27,35
10x50	29,40
10x55	31,40
10x60	33,50
10x65	36,40
10x70	39,40
10x80	45,50
10x90	51,45

ZINCATE BIANCHE	PREZZO
Ø x L	€/100 pz
10x100	57,85
10x120	75,05
12x20	25,85
12x25	28,45
12x30	30,90
12x35	33,10
12x40	35,00
12x45	37,65
12x50	40,30
12x55	43,30
12x60	46,85
12x70	56,05
12x80	64,90
12x90	73,50
12x100	86,55
12x120	110,90
14x30	49,15
14x35	52,75
14x40	54,35
14x45	55,35
14x50	60,05
14x55	64,50
14x70	79,40
14x80	88,65
14x100	108,85
14x120	134,45
16x30	62,05
16x35	66,55
16x40	68,55
16x45	69,85
16x50	75,85
16x60	88,30
16x65	99,05
16x70	99,05
16x80	109,50
16x90	120,95
16x100	134,5
16x120	161,30
18x30	124,75



<b>ZINCATE BIANCHE</b>	<b>PREZZO</b>
<b>Ø x L</b>	<b>€/100 pz</b>
18x35	120,00
18x40	113,00
18x50	123,10
18x80	171,40
18x90	189,25
18x100	210,40
20x30	124,75
20x35	120,00
20x40	113,00
20x45	115,15
20x50	123,10
20x60	140,40
20x70	155,00
20x80	171,40
20x90	189,25
20x100	210,40
20x120	252,35

<b>GREZZE</b>	<b>PREZZO</b>
<b>Ø x L</b>	<b>€/100 pz</b>
5x10	4,000
5x12	3,700
5x16	3,650
5x20	3,850
5x25	4,500
5x30	5,050
5x35	5,850
5x40	6,700
6x12	4,600
6x14	4,700
6x16	4,700
6x20	5,400
6x25	6,100
6x30	6,650
6x40	8,40
6x45	9,25
6x55	12,72
6x60	14,55
8x16	8,35
8x20	8,70
8x25	9,65
8x30	10,70
8x35	12,90
8x40	13,65
8x45	14,70
8x50	15,55
8x60	17,80
8x70	21,60
8x80	27,35
10x20	17,00
10x25	18,65
10x30	20,05
10x35	21,40
10x40	22,85
10x45	24,30
10x50	26,00
10x60	29,60
10x70	34,950
10x80	40,55



DIN 912  
UNI 5931  
ISO 4762



CLASSE 12.9

$\emptyset$	M6	M8	M10	M12
E	5	6	8	10
K	6	8	10	12
D	10	13	16	18
L	8-110	12-110	16-120	20-120

GREZZE	PREZZO
$\emptyset$ x L	€/100 pz
6x20	6,750
6x25	7,600
6x30	8,300
8x20	10,850
8x25	12,050
8x30	13,400
8x35	16,150
8x40	17,050
8x50	19,450
10x25	23,300
10x30	25,100
10x35	26,750
10x40	28,600
10x50	32,50
12x30	34,40
12x35	36,75
12x40	38,75
12x50	44,55